

# +HALFSTREET

AKRIDGE



## PROJECT DETAILS

- + 55,000 SF of Retail
- + Mixed-Use Development Includes Office & Residential
- + Adjacent to Additional Office, Residential & Hotel Development
- + Washington's Next Entertainment District
- + Immediate Access to Navy Yard Metro

streetsense.

[www.streetsense.com](http://www.streetsense.com)

Kelly Silverman, 240.479.7205  
[kelly@streetsense.com](mailto:kelly@streetsense.com)

Jeff Pollak, 240.479.7200  
[jpollak@streetsense.com](mailto:jpollak@streetsense.com)

Guy Silverman, 240.479.7192  
[gsilverman@streetsense.com](mailto:gsilverman@streetsense.com)

# AERIAL

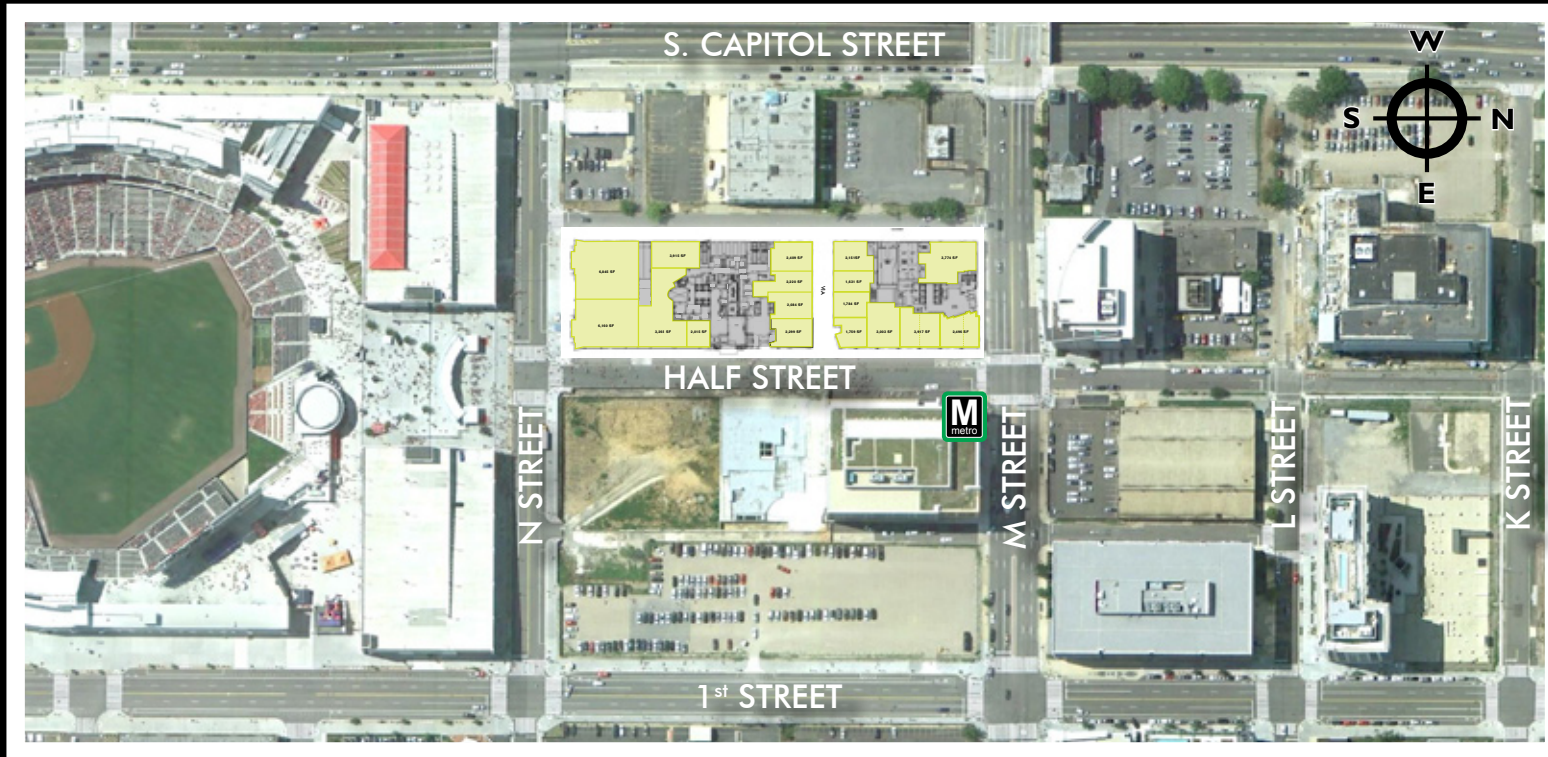

# AREA MAP FEATURING METRO LINES

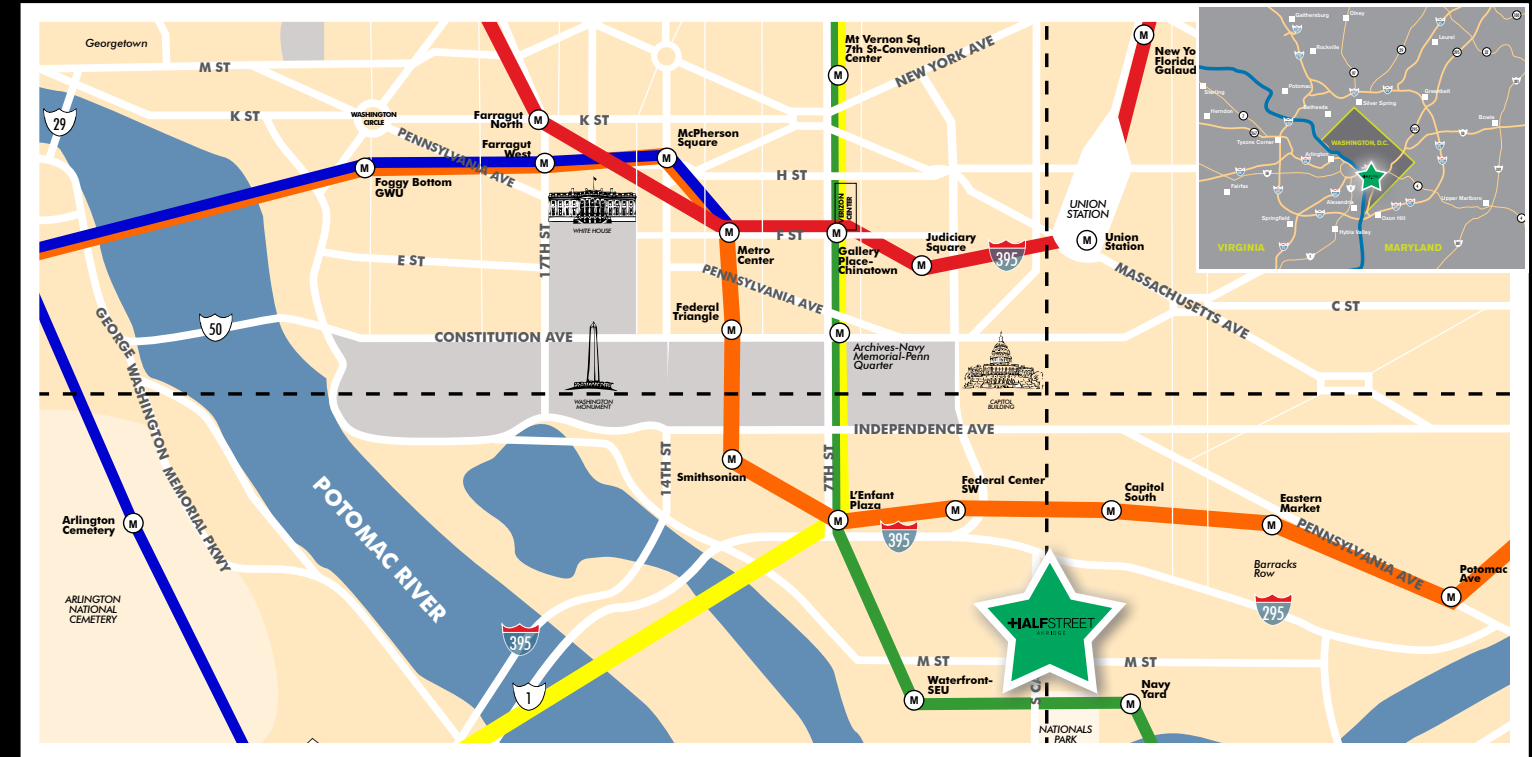

# RETAIL SITE PLAN

Optional Lower Level Space Available for Ground Floor Users

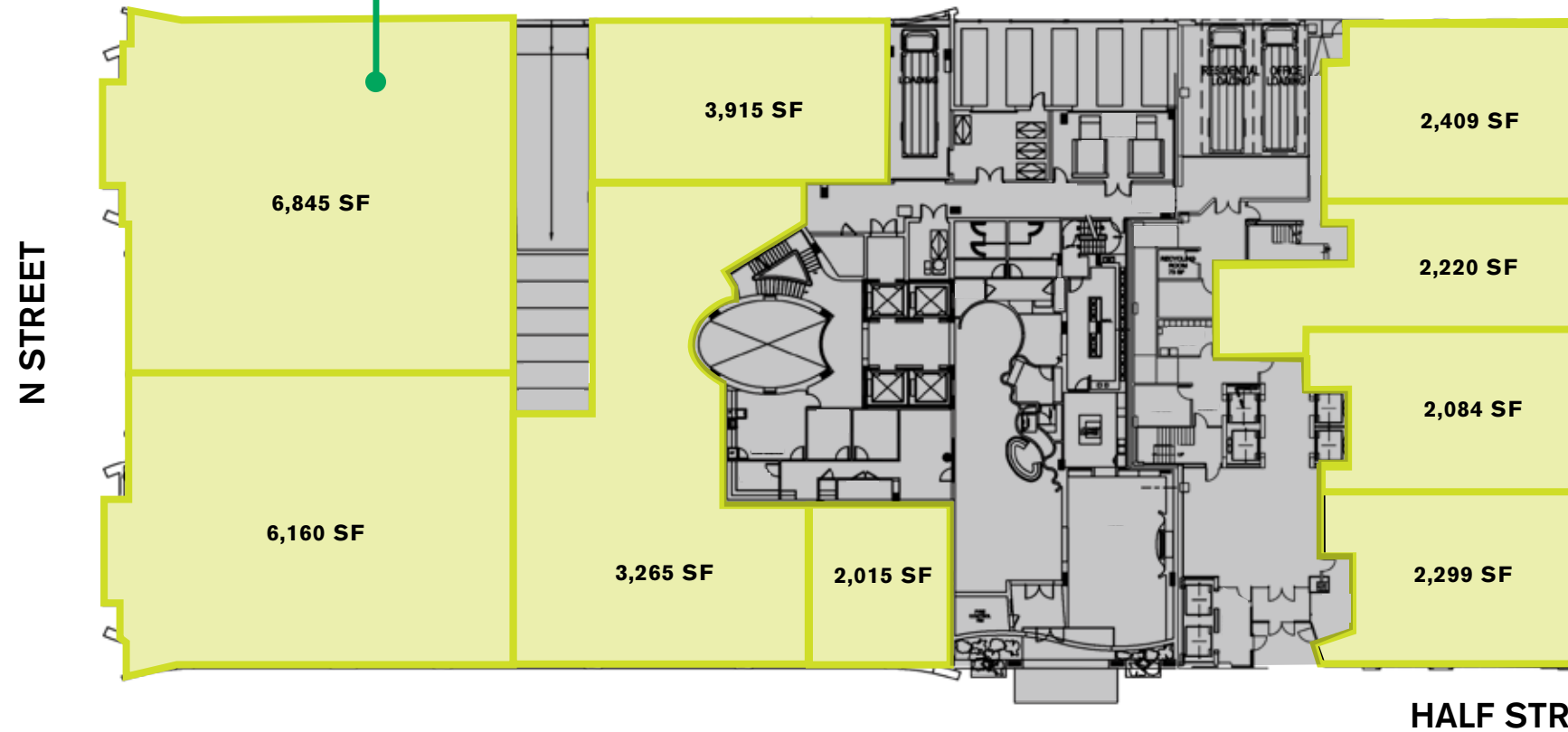

VAN STREET

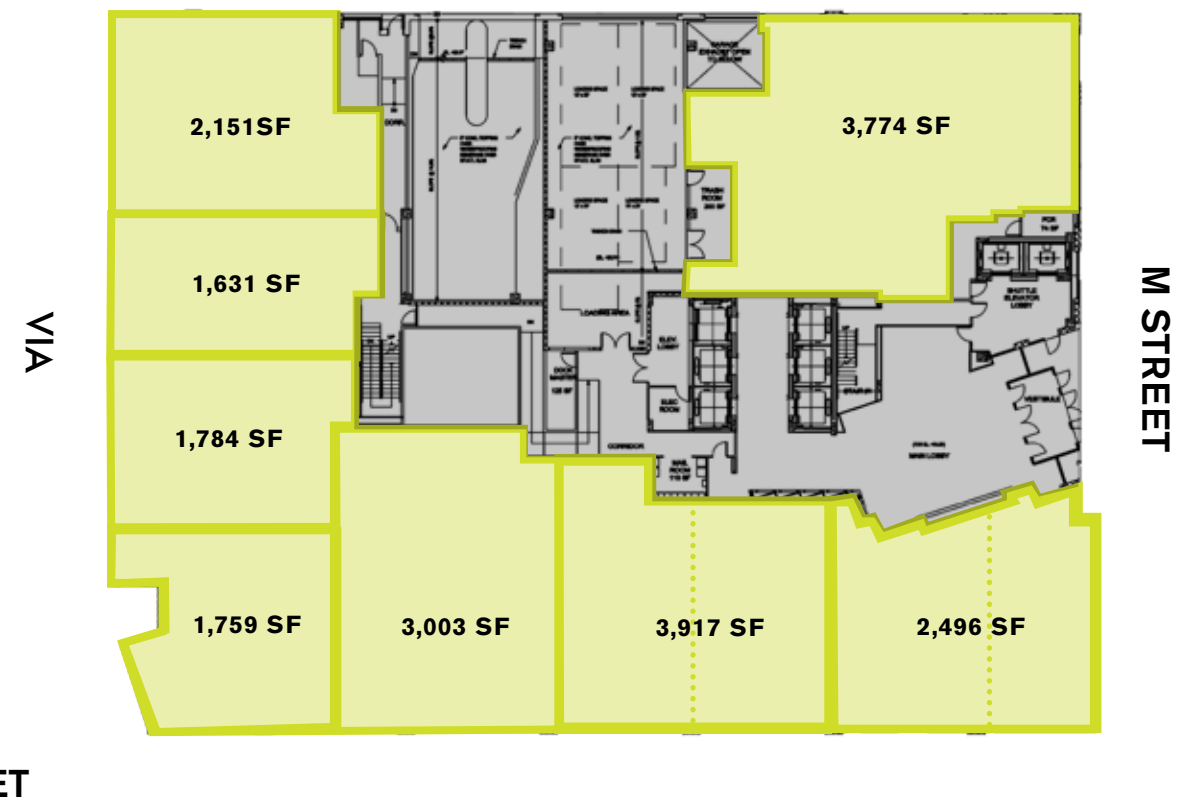

HALF STREET

# AREA MAP

#	PROPERTIES	RETAIL SF
1	1000 South Capitol	TBD
2	1100 South Capitol	TBD
3	1 M Street	15,000 SF
4	Riverfront on the Anacostia	80,000 SF
5	23 I Street	TBD
6	1015 Half Street	21,000 SF
7	41 L Street	5,300 SF
8	20 M Street	10,000 SF
9	50 M Street	5,000 SF
10	55 M Street	15,000 SF
11	W Aloft Hotel	5,000 SF
12	Monument Residential	30,000 SF
13	The 909	6,000 SF
14	Square 740	TBD
15	100 M Street	15,000 SF
16	800 New Jersey	TBD
17	1111 New Jersey	8,000 SF
18	Capitol Hill Tower CO-OP	9,500 SF
19	Courtyard by Marriott	4,000 SF
20	Federal Gateway I	18,000 SF
21	250 M at Canal Park	12,000 SF
22	US Dept. of Transportation	22,300 SF
23	Building 170	7,000-11,000 SF
24	Foundry Lofts	10,000 SF
25	Park Pavilions	40,150 SF
26	300 M Street	3,000 SF
27	Boilmakers Shops	33,540 SF
28	401 M Street	110,000 SF
29	Phase II Dev. Parcels	TBD
30	600 M Street	15,000 SF
31	719 Virginia Avenue	TBD
32	1099 8th Street	10,000 SF
33	The Car Barn	94,400 SF
34	Admiral at Barracks Row	3,000 SF
35	900 M Street	7,480 SF

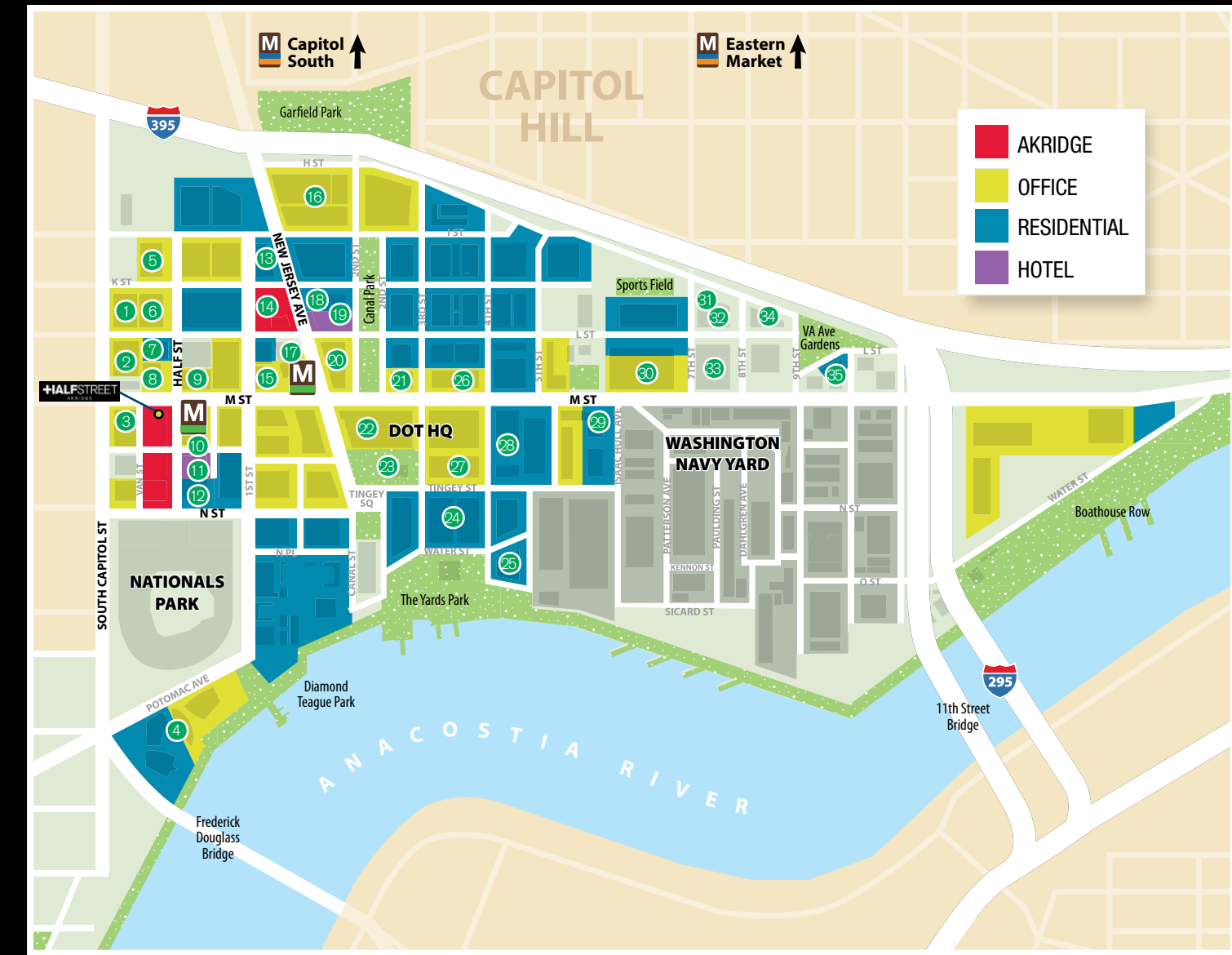

**streetsense.**  
www.streetsense.com

Kelly Silverman, 240.479.7205  
kelly@streetsense.com

Jeff Pollak, 240.479.7200  
jpollak@streetsense.com

Guy Silverman, 240.479.7192  
gsilverman@streetsense.com